

# MOUNTING HEIGHTS OF ELECTRICAL EQUIPMENT IN DWELLINGS

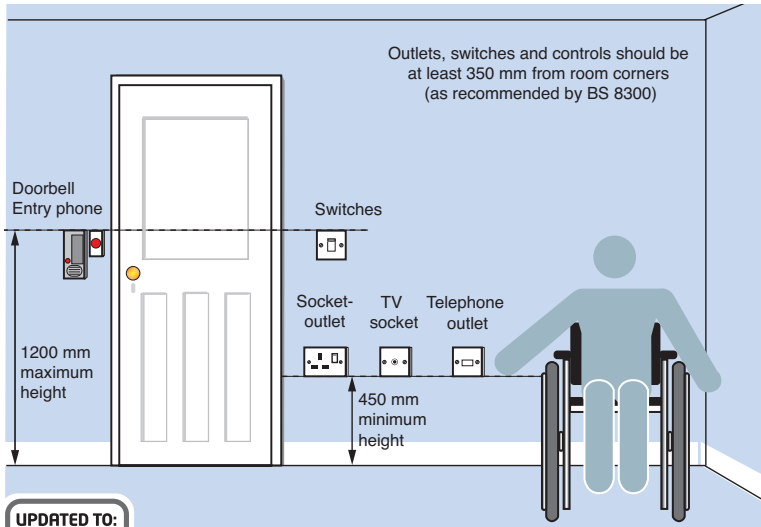

## NOTES (continued overleaf)

- (1) This guide explains the requirements of BS 7671 and Part M of the Building Regulations for England and Wales relating to the mounting heights of equipment in dwellings.
- (2) Part M requires reasonable provision to be made for people to gain access to, and use a building and its facilities. Guidance on meeting the requirements of Part M is given in Approved Document M.
- (3) Section 8 of Approved Document M, which applies to new dwellings, includes the objective of assisting people whose reach is limited to use the dwelling more easily by locating wall-mounted switches and socket outlets at suitable heights.
- (4) A way of satisfying the above objective, as suggested in Approved Document M, is to provide switches and socket-outlets for lighting and other equipment in habitable rooms at appropriate heights between 450 mm and 1200 mm from finished floor level (see diagram).
- (5) Additionally, the mounting height of wall-mounted socket-outlets and other accessories is required to be sufficient to avoid them suffering wetting or impact, such as may result from floor cleaning. Regulation Groups 522.3 and 522.6 of BS 7671 refer.

UPDATED TO:  
IEE WIRING REGULATIONS  
**17<sup>TH</sup>**  
EDITION  
BS 7671:2008



[www.niceicgroup.com](http://www.niceicgroup.com)

For further copies of this guide telephone 0870 0130382 or  
e-mail [customerservice@niceic.com](mailto:customerservice@niceic.com)

© Pocket Guide 7 rev 2 03/08

## MOUNTING HEIGHTS OF ELECTRICAL EQUIPMENT IN DWELLINGS

This is to be avoided

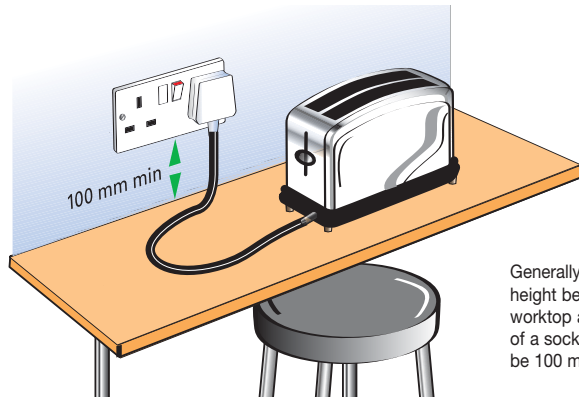
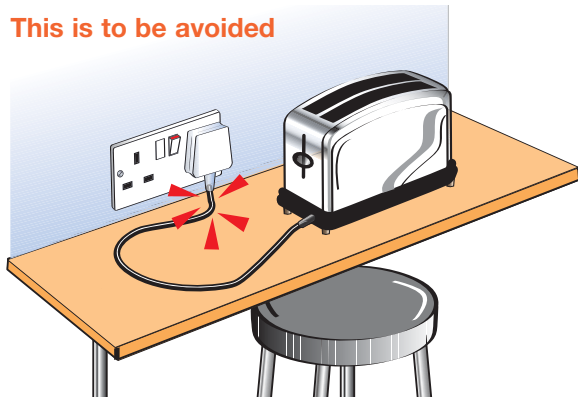

Generally a sufficient height between a worktop and the bottom of a socket-outlet would be 100 mm

### NOTES (continued from overleaf)

- (6) Regulation 553.1.6 requires that a wall mounted socket-outlet is at a sufficient height above the floor or any working surface to minimize the risk of mechanical damage to the socket-outlet or to an associated plug and flexible cord during insertion, use or withdrawal of the plug. See illustrations above regarding socket-outlets above working surfaces. The minimum height above the floor to the bottom of a socket-outlet is 450 mm (see note 4 and diagram overleaf).
- (7) If a dwelling is rewired there is no requirement to provide the measures described in note 4; however, it would be desirable to provide them.